



# Power<sup>3</sup>

## the intelligent Compactus<sup>®</sup>

Power<sup>3</sup> offers high capacity storage with a wide range of intelligent operating functions controlled through a 'one-touch' pad. Ideal for the bulk storage of documents or items that are frequently accessed or where long-term security of the stored items is a priority, Power<sup>3</sup> incorporates all the security features of Archive with additional intelligent safety and security functions.

### **OH & S Conscious**

In today's Occupational Health and Safety conscious environment, Power<sup>3</sup> eliminates risk of operator strain and injury. Power<sup>3</sup> can be linked to climate control, lighting or fire alarms. It also has a night time setting option.



### Motor Current Monitoring System (MCMS)

As a standard safety feature all Power<sup>3</sup> control systems incorporate the MCMS. This system monitors the electric current being utilised by the motor. When the system detects a change in the current due to pressure against a moving mobile the MCMS control system issues an emergency stop command and the mobile movement ceases.



### Motion Detector (Option)

The motion detector is an infra-red motion sensor. When it detects motion in the aisle, the aisle cannot be closed for a certain period of time. One or two sensors can be used per aisle.

### Infra-Red Photo Cell (Option)

When an aisle is closing and the photo cell infra-red beam is interrupted by an object or person the main power to the motors is cut off. Photo cells can be applied to one side or both sides of the aisle.



### Safety Plinth

The safety plinth enables persons in a closing aisle to stop the moving mobiles. By kicking or hitting the lower part of the plinth, the main power to the motors is cut off. Objects left in the aisles will activate safety plinths causing the power to cut off. A safety plinth can be applied to one or both sides of the aisle. The safety plinth acts as an alternative to the infra-red photo cell.

### Passive Block Safety (Option)

A 'passive' safety system forces the operator to look into the opened aisle before another aisle can be opened.

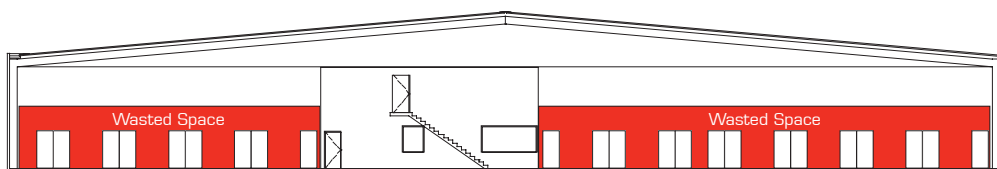

**BEFORE** - Static Shelving

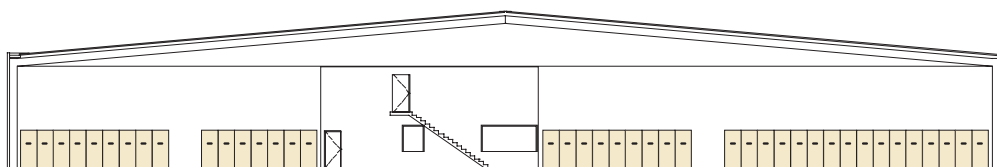

**AFTER** - Power<sup>3</sup>

For contact details, visit [www.dexion.biz](http://www.dexion.biz)



#### Distance Sensor

Soft 'start and stop' ensures vibration-free, safe movement. Programmable distance sensors allow you to adjust the base stopping distance to allow for overhanging materials.



#### Touch Pad

The touch pad is located on the front panel of the mobile or static base. By touching the pad the unit will move either left or right. The touch pad also allows programming and access control via transponder keys.



#### Transponder Keys

There are two kinds of keys - transponder accessing keys and transponder programming keys. The access keys open up secured aisles and programming keys are used to turn on and off program settings.

Specifications	Dimensions
Floor Fixing/Track Infill	Yes
Drive Type	Powered
Max Movable Block Load	10 tonne per base
Max System Depths	12000mm
Bay Heights	1914 to 2994mm in 40mm increments
System Overall Heights	Add 212mm to bay height
Bay Carrying Capacity	Up to 800kg
Bay Width Clear Entry	800, 1000, 1200mm
Bay Clear Depth	25mm shelf heights - Nominal depths 200, 250, 270, 300m 320mm 33mm shelf heights - Nominal depths 300, 320, 350, 370, 390, 400, 450mm
Shelf Carrying Capacity	25mm shelf height - up to 85kg 33mm shelf height - up to 155kg Greater loads by incorporating reinforcement bars.
Shelf Pitch	20mm

# Accessories



## Frames

Frames are available with a unique infill panel.



## Perforated Frames

Perforated frames and infill panels provide greater ventilation.



## Shelf

Shelves are available with or without perforation to accommodate various dividers.



## Reinforcement Bars

Increase the maximum permissible shelf load for steel shelves.



## Sliding Book Support

Available in left and right hand versions and can be locked in any position along the shelf.



## Clamping Divider

To keep rows of books or documents upright.



## Steel Partition Panel

Create closed section partitions.



## Dividing Bars

Divide compartments into a number of open bar partitions.



## Pull-Out Frame

Allows you to store documents in suspension files.



## Pull-Out Shelf

Can be used as a writing desk, work table or for the temporary storage of smaller goods.



## Drawer

Store smaller goods either loose or packed. The drawer may be divided into a number of 55mm sections.



## Sliding Doors

Used to convert open shelving into closed modules for individual security.



## Label Holders

Label holders are used to identify aisles.



## Front Stop

Rod used to create a stop along the front of the shelf.



## Display Shelf and Magnetic Labels

Display shelf presents documents on an angle. Magnetic labels are used for shelf identification.



## Shelf Stop/Middle Stop

Shelf stop creates a positive stop along the front or back edge of the shelf. Middle stop creates and upright edge on double entry racks.