



# Compactus<sup>®</sup> Office

the ideal in-office  
Compactus<sup>®</sup> system

Compactus<sup>®</sup> Office provides high capacity in-office storage together with speed of access. Create additional workspace with this economical solution providing high volume storage of items that need to be close at hand.

**Perfectly Suited to Any Space**

Compactus<sup>®</sup> Office creates a tidy work office environment, enabling you to effectively double your storage capacity instantly, or create extra working space.

**Surprisingly Versatile**

The system can be used as a partition making the cabinets accessible from both sides.



For contact details, visit [www.dexion.biz](http://www.dexion.biz)

**Increase Document Availability**

Quick and easy retrieval of information is critical in today's business environment. Reduce downtime and increase document availability by 100% with Compactus Office as this example shows.

**BEFORE - Static Shelving**

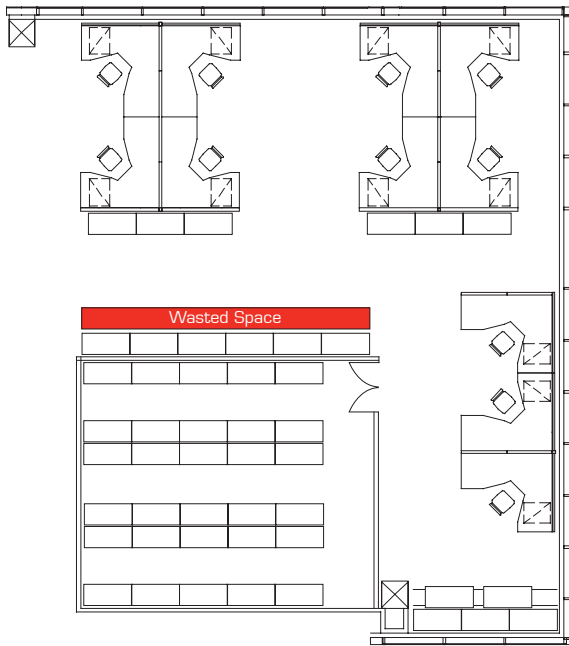

**AFTER - Compactus® Office**

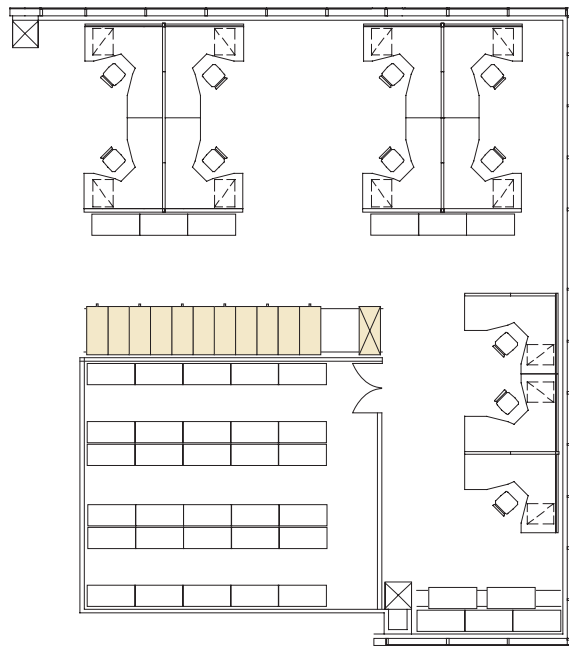

Specifications	Dimensions
Single Stationary Depth	270, 300, 350, 390mm
Double Stationary Depth	400, 500, 540, 600, 700, 780mm
Single Mobile Depth	350 and 390mm
Double Mobile Depth	540, 600, 700, 780mm
Bay Width	1 to 6 bays of 800 or 1000mm
Total Installation Width	Add 243mm to bay width
Bay Height	1194 to 2994mm in increments of 40mm
Total Installation Height	Add 122mm to bay height

\* Other dimensions available request

# Accessories



## Frames

Frames are available with a unique infill panel.



## Perforated Frames

Perforated frames and infill panels provide greater ventilation.



## Shelf

Shelves are available with or without perforation to accommodate various dividers.



## Reinforcement Bars

Increase the maximum permissible shelf load for steel shelves.



## Sliding Book Support

Available in left and right hand versions and can be locked in any position along the shelf.



## Clamping Divider

To keep rows of books or documents upright.



## Steel Partition Panel

Create closed section partitions.



## Dividing Bars

Divide compartments into a number of open bar partitions.



## Pull-Out Frame

Allows you to store documents in suspension files.



## Pull-Out Shelf

Can be used as a writing desk, work table or for the temporary storage of smaller goods.



## Drawer

Store smaller goods either loose or packed. The drawer may be divided into a number of 55mm sections.



## Sliding Doors

Used to convert open shelving into closed modules for individual security.



## Label Holders

Label holders are used to identify aisles.



## Front Stop

Rod used to create a stop along the front of the shelf.



## Display Shelf and Magnetic Labels

Display shelf presents documents on an angle. Magnetic labels are used for shelf identification.



## Shelf Stop/Middle Stop

Shelf stop creates a positive stop along the front or back edge of the shelf. Middle stop creates and upright edge on double entry racks.